



39mm Chrome Fork Assembly fits XL models.

Kits include:

- Chrome Triple Tree Set
- Chrome Fork Sliders
- Chrome Left Side Caliper
- 11.5" Polished Stainless Steel Rotor
- 19" or 21" Wheel Assembly
- Axle
- Fender
- Riser Bushings
- Bearing Set

VT No.	Year	Wheel
24-0991	1982-99	21"
24-0992	1982-99	19"
24-1050	2000-03	21"
24-1051	2000-03	19"
24-1054	2004-up	21"
24-1053	2004-up	19"

39mm Fork Assemblies



24-0992



24-8562



24-8555



35mm and 39mm

Fork Assembly with Polished Lower Sliders. Complete Narrow Glide Fork Assemblies. *Note: Units have chrome lower sliders.

Dual	Single	Year	Model	MM
24-8561	—	1977	All	35
24-8555	—	1978-81	All	35
24-8556	—	1982-83	All	35
—	24-8558	1988-99	883	39
—	—	1995-99	1200	39
—	24-8559	1996-up	XLC	39
—	24-8562*	1988-99		39
—	24-8566*	2000-03	XL	39
24-0380	24-8564	2004-up	All	39
—	24-8565*	2004-up	All	39

Fork Brace



39mm Chrome Fork Braces are machined from Billet aluminum, easy to install and offers increased torsional rigidity. Fits 1987-up XL by clamping over chrome dust boots.

VT No. 24-0841



24-0841
Installed



Tweek Bar Fork Brace is a 2 piece design of polished alloy that clamps directly to fork tube.

VT No.	Size	Fits
24-0824	35 mm	1973-87
24-0823	33.4 mm	1952-72



35mm Chrome Forged Aluminum Fork Brace add rigidity to forks by clamping to fork seal area of lower leg. Fits XL with Showa forks.

VT No. 24-0323

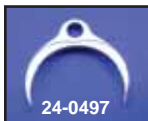

39 mm Kwik-Klip attaches brake line or speedo cable to fork leg.

VT No. 24-1023

24-0497



39mm Triple Trees



Chrome Triple Tree Sets include upper and lower trees to fit 39mm fork tubes as stock on 1990-up.

VT No.	Years
24-0879	1990-03
24-0936	2004-up
2272-5	Screws



Chrome Top Triple Tree for 1988-up.

VT No.	OEM	Year
24-0865	45739-87	1988-2003
24-0898	45966-04	2004-up



39 mm Lower Tree Applications.

VT No.	OEM	Fits	Finish
24-0856	45563-87	88-03 XL	1200 Polish
		95-03 XL	883
24-1020	45563-87	As Above	Chrome
24-0857	45561-87	96-2003 XLC	Polish
24-0665	45561-87	As Above, XLC	Chrome
24-0858	45550-88	88-94 XL	883 Black
24-0897	46126-04	04-up XL's	Chrome



39mm Chrome Single Disc Lower Fork Sliders for XL's.

VT No.	OEM	Brand	Fits
24-0373	45275-98	VT	1988-99
24-0037	46492-00	OE	2000-07
24-0079	46492-00	VT	2000-07
24-0076	46562-04	OE	2008-up
24-0353	46562-04	VT	2008-up
2273-7			Bolt Set



Chrome Lower Triple Tree Cover fits 39mm forks 1987-up designed for easy installation.

VT No. 42-0342



39 mm Fork Tube Assembly includes internals with springs, assembled for 1987-99. Tube length is 23 3/8".

VT No. 24-0107



Lower Fork Stem Retaining Ring for 1986-up all models. Replaces 45611-86.

VT No. 12-0979



Upper Bracket Cover fits 1988-up XL-FXD 39mm forked models, when using a custom bottom mount headlamp.

VT No.	Item
42-0861	Cover
2272-5	Screw Set

Steering Stabilizer Kit

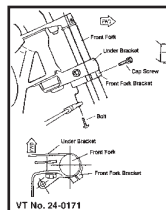

39mm Steering Stabilizer Kit includes brackets and adjustable round body dampener piston. Fits 883-1200.

VT No.	Year
24-0171	1988-03
24-0172	2004-06
24-0664	2007-up

Fork Stops



Stop Plate mounts to custom triple trees under lower bearing for 39mm & 41 mm forks.

VT No. 24-0894



Steering Damper Fork Tube Clamp in alloy finish available in 1 or 2 piece design for attaching damper end to fork tube.

Size	1 piece (A)	2 piece (B)
35mm	31-0419	24-0659
39mm	31-9995	24-0657
41mm	—	24-0658



Billet Fork Stop to be mounted to billet triple tree sets to allow for fork stops. Drilling of tree may be required.

VT No. 24-0749



Steering Damper is universal, multi-position, and adjustable, can be secured between the frame and most forks. Fork tube and frame clamps sold separately.

VT No.	Type
24-0168	Alloy heavy duty
24-0785	Black standard

Chrome Steel Mount Clamp with 3/8" mount hole. Use to mount damper body to frame tube. Sold pairs.

VT No.	I.D.
27-0057	1"
27-0058	1 1/8"
27-0059	1 1/4"



39mm WG Conversion Kits



1988-up Wide Glide Conversion Kit fits XL models with 39mm tubes and single 11.5" disc and 3/4" axle. Include tree set, axle, spacers, lower tree cover and related hardware. Both kits use 1984-99 type front rotors.

VT No. Fits

24-9928 1988-99

24-0595* 2000-up

***Note:** 2004-up models require purchase of caliper & rotor kit 23-0563. 2000-03 require the purchase of 84-99 style rotor.

24-9928 Installed use with stock leg assembly and wheel.



39mm to 41mm Conversion Kit



Narrow Glide Conversion Kit allows use of 41mm leg assembly, 1984-99 style and utilizes the original FXD or XL 19" or 21" wheels, and the caliper and rotor from the original motorcycle. 24-0958 is shown with stock leg assembly 24-0510 FXST style.



Narrow Glide Conversion Kit to fit FXD-XL 39mm models includes upper and lower triple trees, stem, stem nut, fork stops, axle, axle spacers and fender spacers. For use with 1984-99 FXST/FXDWG 41mm fork leg assemblies and 1984-99 narrow glide 19" or 21" wheel assembly with aluminum hub and front fender. Accepts OEM 11.5" rotor and caliper (custom brakes may cause interference with laced wheels). Measures 4^{15/16}" between fender mounts. For front wheel speedometer operation, replace left side axle spacer with speedo drive unit,

VT No. Item

24-0958 Kit

36-2450 Speedo Drive

Fork Stop Tabs fit 24-0958 fork tree set.

VT No. Year Model

24-1204 1982-03 XL

24-1205 2004-up XL

24-1206 1991-up FXD

41mm Narrow Glide

41 mm Narrow Glide will replace 39 mm assembly on XL models. Use with original wheel and brake assembly from 1984-03. Wheel not included.

VT No.	Item	Type
24-1275	Fork Assembly	DD
24-1276	Fork Assembly	SD
52-0170	19" Wheel	SD/DD
52-0171	21" Wheel	SD/DD



XL



33 & 35mm Triple Trees



24-0808



24-0855

Lower Trees. Steel construction.

VT No.	OEM	Years	Tube Size(mm)
24-0807	45703-71	1957-72	33.4
24-0808	45703-73	1973-77	35
24-0930	Chrome	1973-77	35
24-0809	45703-78	1978-81	35
24-0810	47693-81	1982-87	35
24-0855	Chrome	1982-87	35



Top Triple Tree for Sportsters.

VT No.	OEM	Year	Finish
24-0801	45739-62B	1954-72	Cast
24-0802	45738-73	1973-86	Cast
24-0803	45738-73	1973-86	Polished
24-0826	45736-78B	1973-86	Chrome
28-1503	Bushing Set	1954-99	
37-0860	Screw Kit	1962-86	



Fork Stem Lock Tabs replace broken, bent or missing on stock lower triple trees, to be welded on. Fits 1981-83 XLH.

VT No. 51-0099

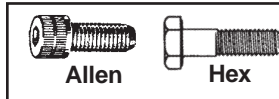

Lower Stem Pinch Bolts.

VT No.	Type	Finish
37-8834	Hex	Zinc
37-9220	Allen	Chrome



37-9220



42-0308



42-0291

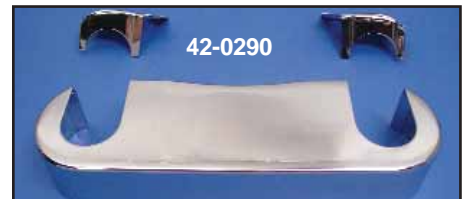

42-0290

Chrome Lower Fork Stem Covers for 1957-85 with 35mm forks. VT No. 42-0290 can be installed without disassembling forks. VT No. 42-0308 replaces 45750-70 in one piece style.

VT No.	Type	Style
42-0308	1 Piece	Smooth
42-0291	1 Piece	XLCH
42-0290	3 Piece	Smooth
8757-8	Allen Screws for Above	

Top Stem Nuts



Chrome Fork Stem Nut Cover to fit over stock stem nut and held in place by set screws. Fits 35mm 1979-87, 1 pc.

VT No. 24-0636

8809-6



Stem Bolt & Cover Kit includes sleeve, stem bolt, dust shield, spacer rubber plug and chrome cover. Fits all 1957-78 without steering damper.

VT No.	OEM	Item
8809-6	Kit	Nut Kit & Cover
8810-2	Kit	Cover
24-0223	45752-52	Spacer
24-0224	45721-54	Sleeve



9978-2



Chrome Domed Shaped Fork Stem Nuts.

VT No.	Fits
7618-1	1952-77
37-0598	1952-77
7619-1	1978-87
9978-2	1988-up

Chrome Flat Top Stem Nut replaces 45718-71 on 1978-86.

VT No.	Item
37-8137	Nut
9963-1	Washer
37-0988	Washer



37-0443

Acorn Stud for use on 1987-up FXR-FXST. Order nut separately.

VT No.	Item
24-1209	Stud
37-0443	Acorn Nut



24-0637



37-9073



37-9073 Installed



24-1278

39mm Chrome Fork Stem Nut Covers fit over stock stem nut and held in place by set screws. 37-9073 includes (2) fork tube cap covers and (1) stem nut cover for 1988-up XL 883-1200.

VT No.	Fits	Type
24-0637	1988-up XL	Stem Only
37-9073	3 piece set	Flat
24-1278	3 piece set	Dome



35 & 39 mm Fork Tube & Slider Assemblies

Fork Tube & Slider Assembly available in right and left pairs, completely assembled. Units have hard chrome fork tubes, and either polished or chrome lower sliders, with springs and all internal components installed. *Note: OE as noted.

39mm

VT No.	Disc	Fits	Slider
24-9965*	Single	1988-93 XLH	Polish
24-0590	Single	1994-99 XLH	Chrome
24-0243*	Single	2000-03 XL	Polish
24-0984		2000-03 XL	Chrome
24-0344*		2004-up XL	Polish

35mm

VT No.	Disc	Fits	Slider
24-9969*	Dual	1977-84	Polish
24-0589	Dual	1977-84	Chrome
24-9938	Dual	+2"	Polish



39 mm Fork Tube Assembly includes internals with springs, assembled for 1987-99. Tube length is 23³/₈".

VT No. 24-0107

Chrome Fork Tubes



Fork Tubes are precision machined with ground finish for fit and quality. Available in chrome or hard chrome as stock. Sold in pairs.

39mm

1988-03 XL models 883-1200, 39mm (Except Hugger)

24-0437 Stock 23³/₈" replaces 45381-87

24-0020 As above Hard Chrome

24-0438 2" over stock

24-0439 4" over stock

24-0442 6" over stock

35mm

1975-83 XLH-XLCH-XLCR, 1983 XLX-XLS

24-0440 Stock 23¹/₄", replaces 45407-75

24-0013 As above Hard Chrome

24-0425 2" over stock, replaces 45644-77

24-0426 4" over stock

24-0427 6" over stock

24-0428 8" over stock

1979-82 XLS models, Showa Fork. 35mm.

24-0425 Stock 25¹/₄" replaces 45644-77

24-0014 As above Hard Chrome

24-0426 2" over stock

24-0427 4" over stock

1973-74 XL, Kayaba Fork. 35mm.

24-0420 Stock 23¹/₂", replaces 45977-73

24-0015 As above Hard Chrome

24-0421 2" over stock

24-0422 4" over stock

24-0423 6" over stock

1984-E86 XL, except sport pkg. 35mm.

24-0429 Stock 23¹/₄", replaces 45407-83

24-0016 As above Hard Chrome

24-0430 2" over stock replaces 45392-83

24-0431 4" over stock

24-0432 6" over stock

L1986-87 XL, 35mm.

24-0434 Stock 23¹/₄" replaces 45407-86

24-0018 As above Hard Chrome

24-0435 2" over stock

24-0436 4" over stock

33.4mm

1954-72 XL

24-0415 Stock 22³/₄" replaces 45953-71

24-0012 As above Hard Chrome

24-0416 2" over stock

24-0417 4" over stock

24-0418 6" over stock

24-0419 8" over stock

Note: See Vintage section for 1952-72 components.

Attention!!

These fork tubes have been manufactured and tested for exact fit and application per model. It can be difficult to identify the front end assemblies because they may not always be original equipment. Before installing, compare old and new tubes. Be sure the stock top plugs fit into the new fork tubes. To avoid scratching the chrome, we suggest that the tubes be lightly rubbed with oil before installing into fork legs. Be absolutely sure you have the right tubes before you install them. No fork tubes can be accepted for return that are scratched or damaged due to improper installation or handling.



33.4, 35 & 39 mm Fork Plugs



Chrome 35 mm Fork Plugs.

VT No.	#	OEM	Year
7622-1	A	45993-73	1973-85
37-8988	A	As Above	Pair
24-0166*	B	45933-74	1974-85
8863-1	A	45993-86	L1985-Mid87

*Note: 24-0166 is drilled & tapped to accept gauge mounts.



Chrome 39 mm Fork Plugs. Replace 45596-87.

VT No.	Year	Type	UM
9913-2	L1987-up	Hex	Ea
9914-2	As Above	Domed	Ea
24-0335*	1988-up	Flat top type	Pair



E-Z Fill Fork Tube Top Plugs feature a small oil fill cap built in to fork tube top plug which will allow fork oil change/fill without removing top fork cap. Pairs.

VT No.	Type	Fits
24-0862	35 mm	1973-85
24-0863	39 mm	1988-up



35 mm Taper-Top Socket Fork Cap Set. Unique tapered style uses hex wrench for installation. Fits 1973-84 XL for Showa and Kayoba.

VT No.	Item
24-0850	Cap Set
24-0616	Washers



Chrome Top Fork Tube Plug replaces 45756-59. Sold each. For 1957-72.
VT No. 7621-1

Fork Springs



Fork Tube Spring Sets feature high tensile strength wire construction with ground ends. Sold in pairs for OEM replacement per the factory number. For more fork spring applications check factory parts book.

VT No.	OEM	Fits	MM
33.4mm			
24-0822	46057-52	1952-70 XLH-XLCH	33.4
24-0900	46057-71	1971-72 XLH	33.4
24-0901	45984-73	1973-74 XL	35
24-0904	45408-75	1976-83 XLH-XLCH	35
24-0903	45987-77	1979 XLS	35
24-0905	45907-80	1980-83 XL	35
24-0910	45907-83	1984-87 XLS-XLX	35
24-0906	46052-80	1980-82 XLS	35
24-0913	45376-87	1987-94 XL	39
		Except Hugger	
24-0933	45372-92	1992-96	39
24-0919	45376-97	1997-2003	39
24-0932	45376-04	2004-up	39



Progressive Suspension Fork Lowering Kits.

Each kit comes with Progressive rate fork springs and spacers. Each kit can be installed at two different levels to lower fork 1" or 2".

VT No.	Fits
24-1560	1988-up
24-1559	1984-87



20th Century Fork Spring Lowering Kits

for Showa forks have progressively wound springs that resist bottoming out.

Installation requires minor disassembly to lower the front forks 1 1/4" or 2" depending on the spacer used. Kit includes springs, spacers and hardware. Easily converts back to stock by reinstalling stock fork springs.

VT No.	Type	Model
24-0160	39mm	1987-up
24-0161	35mm	1975-87
24-0173	39mm	2000-up



39mm Street Tough Fork Springs

by 20th Century Suspension. Progressively wound springs are made using drawn spring wire. Eliminate front end sag, reduce nose dive under braking & improve stability. Fits 1988-91 Showa.

VT No. 24-0164



Progressive Suspension Fork Springs feature high quality, high performance replacement fork springs eliminate front end sag, reduce nose dive under braking, improve cornering stability, increase ride comfort and allow forks to utilize full travel. Sold in pairs.

VT No.	Size	Fits
24-0883	39	2004-up XL's
24-2056	39	1988-up XL Except Hugger
24-2045	39	1992-up XL Hugger
24-2040	35	1952-87 XL-XR



Fork Damper Tubes less hardware, pairs.
VT No. OEM Fits
39mm
24-0464 45925-88 1988-93 XL
24-0476 45925-94 1994-96 XL
24-0477 45925-97 1997-up XL
24-0676 45462-87 1987-up XL, Nylon Ring
24-0677 45460-90 1990-up Dyna Nylon Ring
35mm
24-0456 45913-84 1984-87 XL
24-0457 45980-73 1973-76 XL Kayoba
24-0096 45409-75 1975-83 XL Showa
24-0675 45412-75 1975-86 Nylon Ring



Lower Damper Tube Springs.
VT No. OEM Fits
13-9210 46062-71 1971-72, pair
13-9160 45382-83 1983-86, 10 pk
13-9258 45374-87 1987-up, pair

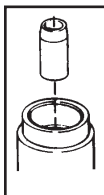

Lower Damper Tube Stop, sold in pairs.
VT No. OEM Fits
24-0459 45918-73 1973-77 XL Kayoba
24-0094 45402-75 1976-83 XL Showa
24-0460 45403-84 1984-87 XLH
24-0466 45463-87 1988-89 XL
24-0375 45361-90 1990-up XL

Fork Drain Plugs



9907-4



9910-4



24-0010

Fork Drain Screws are supplied with washers, pair.
VT No. OEM Use Finish
9907-4 46201-52 1952-72 XL-K Chrome
 6218W
9908-4 As Above Cadmium
9910-4 45790-80 1973-up Showa Chrome
 45986-73
24-0010 45790-80 1976-up Showa Chrome

Drain Screw Fiber Washers available in 10 packs.
VT No. OEM Years Use
14-0959 6218W 1952-72 Early XL
14-0019 45986-73 1973-75 Kayoba
14-0020 45403-75 1976-up Showa

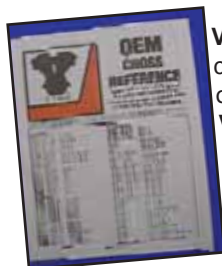
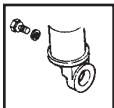

V-Twin™ OEM Cross Reference Guide with cross factory number to V-Twin Numbers on over 20,000 items.
VT No. 48-0011

The Most Comprehensive in the Aftermarket Industry!

Fork Damper Tube



24-0475

Fork Damper Tube Kit includes for 2 sides, damper tubes with rings, screws and washers, lower stops, slider seal washers and retaining rings.

VT No.	Type	Fits	MM
24-0454	Steel Leg	1971-72 XL	33.4
24-0452	Kayoba	1973-76 XL	35
24-0446	Showa	1976-83 XL	35
24-0453	Showa	1984-87 XLH	35
24-0473	Showa	1988-93 XLH	39
24-0474	Showa	1994-96 XLH	39
24-0475	Showa	1997-up XLH	39



Damper Tube Screw.
VT No. OEM Type
24-0188 45995-73 Kayoba, 1973-86
24-0787 45405-75A Screw pair w/ washer, showa
24-0786 Showa Screw only, 5 pk



Damper Tube Washers in 10 pack.
VT No. OEM Fits
14-0017 45992-73 1973-74 XL Kayoba
 Fiber
14-0018 45406-75 1975-up XL Showa
 Copper



Internal Fork Damper Valve actively creates a compliant ride due to the detailed design of its control valve. Fit 39mm.
VT No. 24-0360

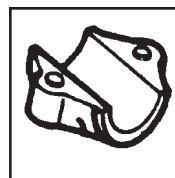

Narrow Glide Axle Cap, alloy finish.
VT No. OEM Side Year
24-0505 45410-75 Left 1975-83
24-0506 45410-84 Left 1984-87
24-0507 45994-77 Right 1975-83
24-0508 45994-84 Right 1984-87



Fork Boot Covers



2 Piece Chrome Fork Boot Cover Sets install overstock rubber fork boot by the unique interlocking springs, supplied with the kit, to securely hold boot covers in place. 35 mm. Fits 1973-87.

VT No. 24-9992



"Gator" Fork Boots are flexible type for 39mm forks. Rubber boots are 230 mm long, black, pair.

VT No. 28-0440



39mm Fork Gator fits
Nightster XL-FXD.
VT No. Type
28-0758 XLN
28-0885 V-Twin

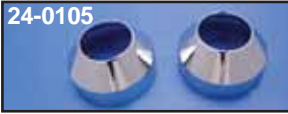

Chrome Wiper Boot Covers are die cast to fit over the stock rubber fork wiper boot.

VT No.	Type	Year	MM
24-0104	Kayoba	1973-74 XLH	35
24-0105	Showa	1975-87 XL	35
24-9939	Showa	1988-up XL	39

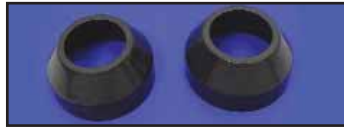

Black Rubber Fork Boots are designed for a better fit and improved sealing and wiping action. Sold pairs.

VT No.	OEM	MM Fits
28-0900	46001-71	33 1971-72
28-0902	45983-73	35 Kayaba forks 1973-74
28-0903	45404-75	35 Showa forks 1975-87
28-0905	—	35 As Above White



39mm Fork Boot Cover Dust Shield Kit fits 1988-up.

VT No.	Item
24-0090	Complete Kit
14-0956	Seals only

Fork Seal Kits



GB Deluxe Fork Seal Rebuilding Kits include all pieces illustrated as appropriate for each application.

VT No.	Fits	Size
14-0702	1973-74 Kayoba	35 mm
14-0703	1975-84 Showa	35 mm
14-0704	1988-up Showa	39 mm
14-0705	1984-87 Showa	35 mm



Leak Proof Fork Seals feature a Teflon coating to reduce drag and carry a manufacturer's lifetime guarantee, sold in pair.

VT No.	Size	Year
14-0250	35 mm	1973-74 XLH-XL Kayaba
14-0251	35 mm	1975-87 XL, Showa
14-0024	39 mm	1988-up XL

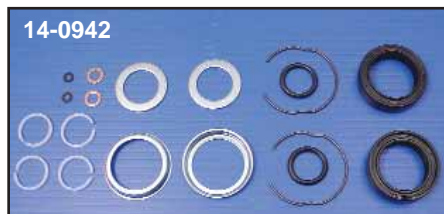

V-Twin Deluxe Seal Kits include seals, gaskets, snap rings, washers and o-rings. James Kits include seals and o-rings only.

James VT No.	MM	Year	Fits
— 14-0043	33.4	1952-70 XL-XLH,	Gasket only
14-0039 14-0940	33.4	1971-72 XLH-XL	
14-0040 14-0941	35	1973-74 XLH,	Kayoba
14-0041 14-0942	35	1975-84 XL Showa	
14-0044	—	35 1984-87 XL	
14-0042 14-0943	39	1988-07 XL	
14-0047	39	2008-up XL	



Fork Seal Sets are molded with factory part number, sold in pairs for XL models.

VT No.	OEM	Years	MM
14-0010	45975-71	1971-72	32.5
14-0013	45927-73	1973-74	35
14-0011	45400-75	1975-82	35
14-0016	45387-83	1982-87	39
14-0021	45378-87	1988-up	39
14-0956	45401-87	1988-up Dust Seal	

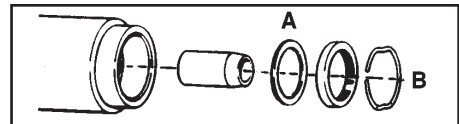

A-Slider Seal Washers are zinc plated.

VT No.	OEM	Year
24-0642	45928-73	1973-76
24-0091	45911-80	1980-83

Fork Seal Retaining Ring.

VT No.	OEM	Year	Model
24-0641	45931-73	1973-76	XL
24-0613	45401-75	1975-80	XLH
24-0614	45908-80	1980-87	XL
24-0623	45905-87	1988-up	XLH



Fork Seal Spacer. Fits 1986-87. Replaces 45386-83.
VT No. 24-0627



Ball Bearing Neck Cups available in pairs as zinc cups only or chrome kit with races & balls. Fits 1952-77 Sportster.

VT No.	OEM	Finish
24-0110	48310-30	Zinc Cups
24-0135	Cpt. Kit	Chrome
24-0195*	Cpt Kit	Chrome
12-0157	8860	5/16", Balls, 50 pieces
24-0099		Upper and Lower Race
24-0621		Bottom Race Only

*Note: Includes top nut, sleeve and dust cover.



Fork Stem Bearings and Races.
Order separately as noted for 1982-up XL.

VT No.	OEM	Item	U/M
24-0118	48360-60	Bearings	Pair
12-0384	Peer	Bearings	Pair
12-0335	Timken	Bearing	Each
12-0348	48315-60	Race	Each
12-0383	Peer	Race	Each



Dust Shield Sets include upper and lower for 1982-up.

VT No. Finish
24-0117 Zinc

24-0114 Chrome



Bearing Seal Set fits 1982-up XL models.

VT No. 14-0174

Neck Cup Kits



Neck Cup Kits for Sportster to convert 1952-77 ball bearing style cups to Timken tapered type. Complete conversion kit includes 2 chrome cups, 2 tapered bearings and dust shields, 1978-up types are for stock replacement.

VT No.	OEM	Year	Item
24-0225	Kit	1952-77	Complete Kit
24-0232	Set	1952-77	Bearing Set
24-0233	Set	1952-77	Dust Covers
24-0157	Set	1952-77	Cups with Races
24-0338	48310-78	1978-81	Cups with Races
24-0101	45586-78	1978-81	Bearing Set
12-0354	As Above	Each	
24-0221	45597-78	1978-81	Upper Dust Shield
24-0619	48370-78	1978-81	Lower Dust Shield
24-9935	All	1979-81	Kit w/2 Dust Shields
24-9936*	All	1982-up	Kit w/2 Dust Shields
24-0118	Set	1982-up	Bearings Only
24-1098	Set	1978-81	Cups without races

*Note: Does not include neck cups.



Dust Shields zinc plated.

VT No.	OEM	Fit	Model
24-0221	45597-78	Upper	1979-81
24-0618	48361-80	Upper	1982-up
24-0112	48365-48A	Lower	1982-up
24-0619	48370-78	Lower	1979-81
24-0111	48370-52	Upper	1952-78
14-0174	48184-01	U/L	2001-up



Neck Cup Kit features solid internal fork stops that are built into the cups & hidden away. Fits stock & custom rigid frames that accept stock XL neck cups. Kit includes cups, races, bearings & covers. Drilling & triple tree

required at bearing area. Fits 1957-81.

VT No. 24-0236

"Raked" Neck Cups



"Raked" Chrome Neck Cup Kits provide 3° rake when installed.

VT No.	Year
24-0289	1952-77
24-0291	1978-81



1982-up "Raked" Chrome Neck Cup Kit includes longer stem. Rake requires long fork tubes & neck lock cannot be retained.

VT No.	Stop	Year	Degree
24-0294	Tab	1988-03	3°
24-0376	Plate	1982-up	3°
24-1285	Plate	1982-up	5°
24-1267	Plate	1982-up	7°



Note: Rake Neck Kits are for **Show Applications** only and **Require** longer Fork Tube to be **Installed**.



Kickstand

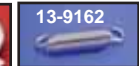
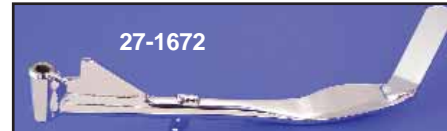
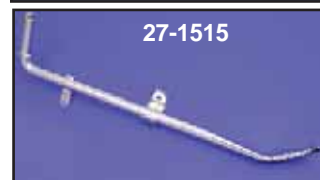
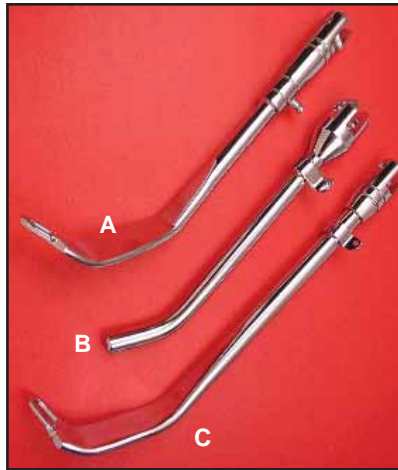

Forged End Kickstands in chrome.

VT No.	#	OEM	Years	Length
27-0509	A	50006-80	1952-83	Stock
27-0689	—	—	1957-83	Stock
27-1688	B	50062-52A	1952-79	Stock
27-0510	C	Extended	1952-83	2-4" Stand
37-9117		Fits A & C		Pin
27-1500		Fits B		Pin
13-0154		50011-30	1952-83	Spring

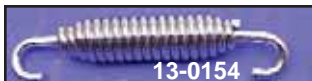

Chrome Kickstand Springs

VT No.	Years
13-0154	1952-83
13-9159	1984-88
13-9162	1989-06
13-0545	2007-up
28-2234	1990-up Bumper Stop

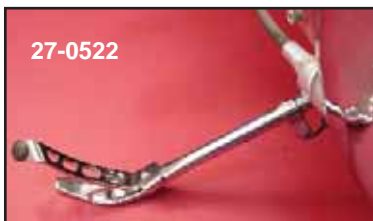

1984-up Kickstands.

VT No.	OEM	Year	Item
27-0520*	50072-92	1990-03	Short Stand
27-0047	50006-84A	1984-88	Stock Stand
27-1515	Extended	1984-88	4-6" Stand
27-0048	50038-84	1984-88	Catch
13-9159	41836-84	1984-88	Spring
27-1668	50006-89	1989-03	Stock Stand
37-9153	50003-89A	1989-up	Pin
13-9162	50005-85A	1989-up	Spring
27-1672	50185-04	2004-up	Stock Stand
27-1730	50238-07	2004-up	1" Lower
27-1516		1989-03	Bushing Set

*Note: Hugger type for lower shocks.



Weld On Kick Stand

Assembly includes weld on type heavy duty mount, chrome spring and chrome kick stand with forged flat end.

VT No. Item

27-0257 Kit

27-0795 Bushing



Kickstand Extensions allow rider to more readily access side stand. Replaces 50212-98 & fits 1984-up.

VT No.	OEM	Model
27-0522	50212-98	1984-2003 XL
27-0025	50250-04	2004-up XL

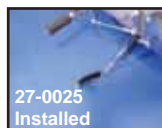

Kickstand Pad has a 4" diameter surface. Fits in saddlebag or tool pouch to support stand on soft pavement, each.

VT No. 48-0630

Kickstand Tab & Pin for 1952-83. Tab is for weld on repair. Pin includes screw.

VT No.	Item
51-0515	Repair tab
27-1500	Pin kit



1952-81 K/XL Center Stand is constructed of cast aluminum and includes spring and hardware for mounting to stock swing arm frames. Replaces 49701-57.

VT No. 27-0548



Driver Footpeg Supports



Foot Rest Supports and Studs.

VT No.	OEM	Years	Item
Left Side			
27-1556	50948-75	1977-85	Support
12-0552	24752-75	1977-85	Stud
27-0044	50948-86A	1986-90	Support
12-2118	24752-86	1986-90	Stud
27-1638	50951-90	1991-03	Support
27-0817	—	2004-up	Support
Right Side			
23-3024	34886-86A	1986-90	Stud
27-1577	50949-75	1977-79	Support
12-2117	247751-75	1977-79	Stud
23-3079	42441-90A	1991-03	Peg Clevis
23-3015*	42441-80	1980-90	Pivot-Stud
23-1728	34909-83	1983-90	MC Support Bracket
23-3080	34909-90	1991-03	MC Support Bracket

*Note: Acts as foot support brake pivot.

Driver Peg Support Bars are the splined type, less pegs fit 1952-74. Replaces 50948-71 left, 50949-67 right. Use with large female type driver pegs.

VT No.	Finish
27-1624	Zinc
27-1735	Chrome

2004-up Chrome Forward Control Footrest Support fits XLC models with forward controls.

VT No. 27-0010

Rear Peg Mounts

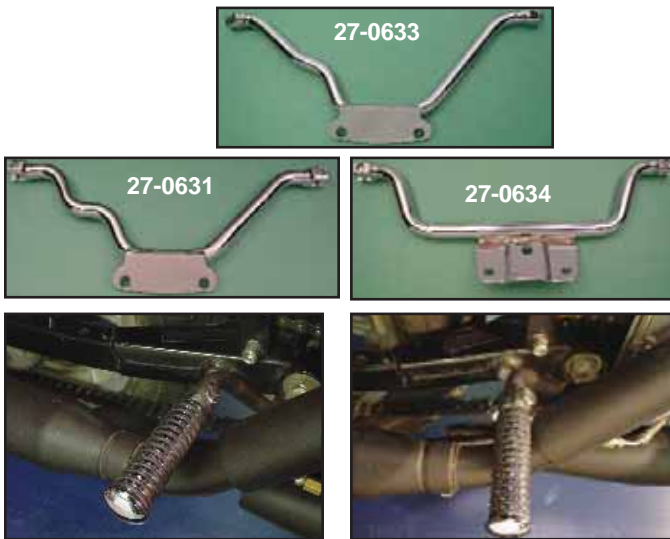

VT No. 27-0634 Shown on motorcycle

Chrome Rear Footpeg Brackets bolts to rear motor mount bolts, for use on Rigid or Swing Arm frames.

VT No.	Fits
27-0633	1957-78 Sportster, uses large female Driver pegs 27-1215, 27-1220 & 27-1581
27-0634	1982-90 XL use 27-1227 Small Male Pegs
27-0631	1957-81 except 1979 use 27-1227 Small Male Pegs

Footpeg Spring for right side 1954-78 rear passenger replacing 52697-59, pair.
VT No. 13-9230

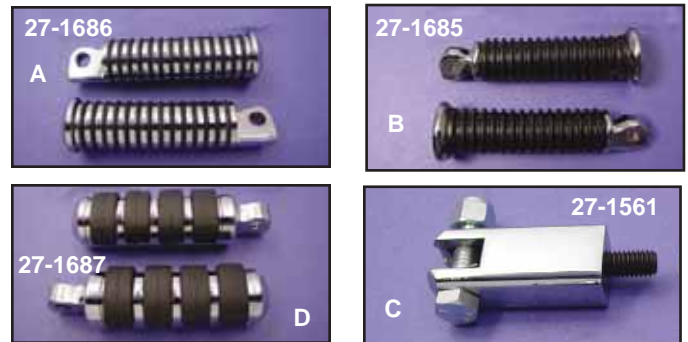
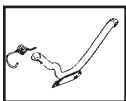

Rear Passenger Peg Mounts (D) Replaces 50610-86 on 1986-2003 models, to mount rear passenger pegs to swing arm. Choose pegs to complete or order kit.

VT No.	#	Item
27-1686	C-A	Kit
27-1685	C-B	Kit
27-1687	C-D	Kit
27-1561	C	Mounts Only



2004-up Chrome Passenger Peg Mount Bracket Sets Only. Use with male style peg.
VT No. 27-1564



Rear Passenger Peg Relocation Bracket Set fits 2004-up XL with 30-0300 pipe set. Black finish. Order chrome footrest for support bracket separately.

VT No. 31-0766