



Wheel Rims



Drop Center Chrome Rims features drop center design for bead and 40 spoke holes. All are chrome unless noted.

Note: Large hole accepts rubber valve stem tube. Small hole accept metal stem tubes.

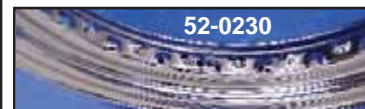

16" Rim with Large Valve Stem Hole

VT No.	Width	Brand
52-0224	3.0"	V-Twin
52-0226	3.0	Perma Chrome
52-0699	3.0"	As Above Raw
52-0692	3.0"	Black Gloss
52-0223	4.0"	V-Twin
52-0303	4.0"	Replica

16" Rim with Small Side Valve Stem Hole

52-0689	3.0"	CMR
52-0225	3.0"	As Above, 1997-up
52-0230	3.0"	As Above Center Valve
52-0222	3.0"	Perma Chrome
52-0143	6.0	Perma Chrome
52-0691	3.5"	AWW
52-0228	4.5	Perma Chrome

15" Rim with Large Valve Stem Hole

52-0220	3.0"	V-Twin
---------	------	--------

18" Rim with Center Hole

52-0707	2.5"	V-Twin
52-0229	4.25"	Perma/Chrome

17" Rim with Center Hole

52-0435	4.5	OE
---------	-----	----

18" Rim

52-0229	4.5"
---------	------

Chrome Replica Drop Center Front Rims. 2.50" x 19"

VT No.	OEM	Brand
52-0700	43018-73	Perma Chrome
52-0977*	43002-70	V-Twin
52-0688	43001-79	OE

***Note:** Fits 1964-72 Drum Brake Only



Front And Rear Wheel Hubs

All Hubs include bearings, races, seals, seal spacers and are assembled and chromed except where noted.

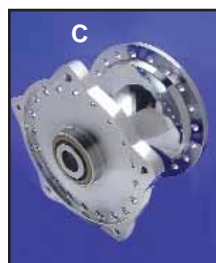
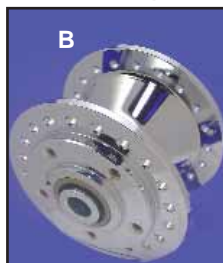
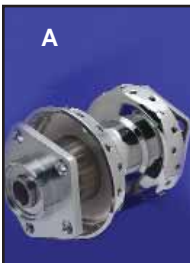

Rear Hubs

VT No.	#	OEM	Fits
45-0673		Cpt	1967-72
45-0306		Bare	1967-72
45-0758		Bare	1967-72 (Black)
45-0317	A	43540-73A	1973-E82 FX-FL-FXE 3/8" & 7/16" Holes
45-0303	A		1973-82 without bearing set
45-0670	A	40952-82A	82-85 FXE-FXWG-FXR, 84-85 FXST

***Note:** Includes one bearing and spacer.

Front Hubs

VT No.	#	OEM	Fits
45-0317	A	43540-73	1973-84 FLH-80 3/8" Disc Mount Hole
45-0297	B	43600-73	1973 only FX
45-0307	C	43600-74	1974-77 FX, SD
45-0308*	C	—	As above, Satin
45-0310	B	43600-78	1978-83 FX-FXE- FXEF-FXEF-80-FXE-80 1982-83 FXR-FXRS DD

45-0311*	B	—	As above, Satin
45-0312*	B	—	As above, Polish

45-0294	A	43663-80A	1980-83 FXWG DD 5/16" Disc Bolt Holes
---------	---	-----------	--

***Note:** Internals not included, order separately

Replica Star Hubs include all internal parts, completely assembled, for front and rear.

VT No.	OEM	Year	Finish
45-0335	3958-36	1936-40	Parkerized
45-0880	3958-36	1936-40	Black
45-0330	43540-36	1941-66	Chrome
45-0323	43540-36	1941-66	Black



Spoke Set Chart



Flat Flanged Hubs. Front & rear hubs (45-0317, 45-0670, 45-0330, 45-0306 with horizontal flanges) including 1936-84 FL-FLH front and rear, 1973-84 FX-FXE rear, 1954-99 XL Rear, 1984-95 FLST-FXST-FXDWG front or rear, 1996-up FLST-FXST alloy rear, 1986-up FLT rear, 2000-up XL alloy rear and 1996-up Dyna alloy rear. **All Spokes Listed Are 6-8 Gauge with short shank.**

SPOKE SETS FOR FLAT FLANGE HUBS										
Chrome V-Twin	Chrome Buchanan	Chrome Twirled V-Twin	Chrome Twirled Buchanan	Stainless Twirled V-Twin	Stainless Twirled Buchanan	Chrome Diamond V-Twin	Chrome Diamond Buchanan	Size	Rim Type*	Note
45-0620								15"	DC	
45-0621	45-0720	45-0703	45-0675	45-0709	45-0698		45-0682	16"	DC	3
45-0762		45-0765						17"	DC	4
45-0601	45-0721							18"	C	
45-0610								18"	DC	
45-0602			45-0727		45-0729			19"	C	
	45-0728		45-0730					19"	DC	1
45-0603	45-0723	45-0706	45-0677	45-0726	45-0700	45-0716	45-0684	21"	DC/C	

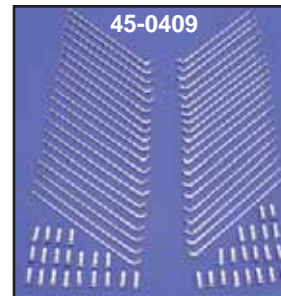

SPOKE SETS FOR FLAT FLANGED HUBS						
Chrome Rippled Buchanan	Stainless V-Twin	Stainless Buchanan	Cadmium Plated V-Twin	Size	Rim Type*	Note
		45-0650		15"	DC	
45-0731	45-0409	45-0651	45-0710	16"	DC	3
	45-0748	45-0652		18"	C	
		45-0656		18"	DC	
		45-0653		19"	C	
		45-0654		19"	DC	1
		45-0674		19"	DC	2
	45-0713	45-0655		21"	DC/C	

Notes:

1. Fits Disc Type Spool Hub Only
2. Fits Drum Type Spool Hub Only (Cross 3)
3. VT No.45-0409 is Hand Polished
4. Use with rim 52-0435
5. Fits 1995-up FXD-XL Applications.

*Note: Rim Type Drop Center = DC or Conventional = C

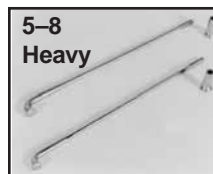

16" Heavy 5-8 Gauge Spoke Set in chrome or stainless finish.

VT No.	Finish
45-0737	Chrome
45-0738	Stainless



6/8 Gauge Nipple Set fit our spoke sets, 40 pieces.

VT No.	Type
45-0626	Chrome Standard
45-0101	Chrome Replica
45-0680	Stainless Standard
45-0749	Chrome Extended
45-0750	Stainless Extended

1973-up Alloy Hub Spoke Sets with Single or Dual Disc with vertical flanges to house spokes. Sets include 20 long and 20 short shank spokes. Shank is 8 gauge portion which fits in hub flange with 40 nipples.

All Spokes Listed Are 6-8 Gauge

Twirled-Diamond-Stock are noted as the following:

- B** Twirled Buchanan
- B** Twirled v-Twin
- A** Diamond Buchanan
- C** Ripple Style

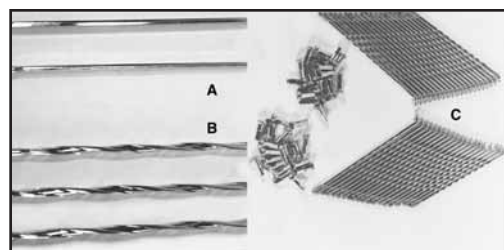

SPOKE SETS FOR ALLOY FRONT DISC SPOOLS											
Chrome V-Twin	Chrome Buchanan	Chrome Twirled V-Twin	Chrome Twirled Buchanan	Stainless Twirled Buchanan	Chrome Diamond Buchanan	Chrome Rippled Buchanan	Stainless V-Twin	Stainless Buchanan	Size	Rim Type*	Note
45-0606								45-0661	19"	C	
45-0623	45-0718	45-0705	45-0676	45-0699	45-0683		45-0714	45-0660	19"	DC	
45-0607	45-0719	45-0751	45-0686	45-0701	45-0687	45-0755	45-0612	45-0662	21"	DC/C	
45-0611							45-0612		21"	DC/C	5



1936-66 Replica Wheels

52-0100



52-0876



52-0098 with
120 x 21 Avon
installed



1936-66 BT Star Hub Type Wheel includes chrome hub, chrome rim and choice of chrome or stainless spokes. Fits front or rear and hub and is assembled like stock with loose type roller bearings. All wheels include rubber rim strip installed.

Chrome	Stainless	Diameter	Width	Chrome	Stainless	Diameter	Width
52-0100	52-0800	16" F & R	3.00"	52-0102	—	19" Front	1.85"
52-0876	52-0877	18" F & R	2.15"	—	52-0801	19" Front	2.15" (D. C.)
52-0831	52-0832	16" Rear	4.00"	52-0103	52-0802	21" Front	2.15"
52-0115	—	18" Rear	4.25"	52-0098	—	21" Front	2.15" (D.C.)



52-0847



52-0881
18"



52-0866



1936-66 BT Star Hub Type Wheel includes black hub with choice of chrome replica rim and chrome spokes or black replica rim and stainless steel spokes. All wheels include rubber rim strip installed. ***Note:** With SS spokes.

Chrome Spokes & Rim	Black Rim S.S. Spokes	Diameter	Width	Chrome Spokes & Rim	Black Rim S.S. Spokes	Diameter	Width
52-0847	52-0866	16" F & R	3.00"	52-0878	52-0881	18" F & R	2.15"
52-0880*	—	16" F & R	3.00"	52-0886*	—	18" F & R	2.15"
				52-0887	52-0889	19" F & R	2.15"

All Wheels include V-Twin's Replica Star Hub which will accept original type axles and sleeves.



18 x 4.25" Rear Wheel includes chrome steel hub and spokes. Accept 150 thru 180 series tires. Fits 1973-84 FX-FL.
VT No. 52-0776

Replica Big Twin Rear Wheels



52-0129

Wheel Builders



Since 1969

Complete Wheel Assembly

features the following:

- Chrome Rim
- Chrome or Stainless Spokes
- Chrome Hub with Internals
- 40 Spoke Style.



52-2034



52-0937

Chrome Spokes	Stainless Spokes	Rim Diameter	Rim Width
1973-82 FX-FXE, 1973-84 FL-FLH Front or Rear, 3/8 Disc Mount Holes with internals.			
52-0182	52-0811	15"	3.00"
52-0129	52-0179	16"	3.00"
52-0863*	52-0864*	16" Deluxe	3.00"
52-0126	52-1094	16"	3.50"
52-0937	52-0938	16"	4.00"
52-2034	—	17"	4.50"
52-0776	—	18"	4.50"
52-0814	52-0812	19"	2.50"
52-0815	52-0813	21"	1.85"
1982-84 FXE, 1982-86 FXWG, 1982-85 FXR 1984-85 FXST			
52-0168	52-0809	16"	3.00"

*Note: Deluxe rims are OE type.

1967-72 Wheels



52-0106

1967-72 BT Wheel Assembly fits front or rear includes lock, screw, seal spacer, tube spacer and 1 bearing.



Internal Bearing & Hardware Kit for 1967-72 front and rear hubs. All parts necessary to build or rebuild a bare hub. Includes 3 bearings, tube spacer, seal, seal sleeve & hub lock (Left Hand Thread). Complete.

VT No. 44-0410

Chrome Spokes	Stainless Spokes	Width	Diameter
52-0146*	52-0745*	3.00"	16" Front or Rear
52-0106	52-0803	3.00"	16" Front or Rear
—	52-0804	4.00"	16" Rear
—	52-0124	2.50"	19" Front
52-0123	52-0806	2.15"	21" Front

*Note: Assembled with black finish hub.

Note: 1967-72 type Hub utilizes 1 bearing in Hub and must be supported on the other side by a brake drum or our adapter VT No. 45-0314. Front drum uses 1 bearing, rear drum sprocket, 2 bearings.

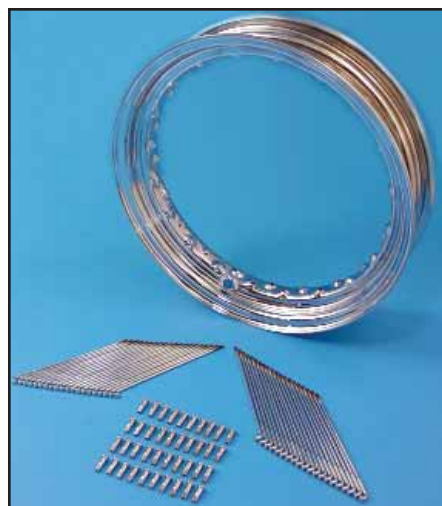

Chrome Spoke and Rim Set includes chrome rim with 40 chrome 6-8 gauge spoke and nipple set. Fits 1936-up Big Twin, 16" x 3.0"
VT No. 52-0300



Front Wheels for 35mm Forks

These replica wheels bolt on to stock applications as listed with no modifications.



Replica Front Wheels

52-0129



For 41mm forks as noted

W/Chrome Spokes	Stainless Spokes	Rim Diameter	Rim Width
1973-84 FLH with single disc. Fits 41mm forks.			
52-0129	52-0179	16" D.C.	3.00"
52-0815	52-0813	21"	1.85"
1980-83 FXWG with dual disc. 5/16" rotor mount holes. Fits 41mm forks.			
52-0131	52-0132	16"	3.00"
52-0821	52-0822	19"	1.85"
52-0128	52-0820	19" D. C.	2.50"
52-0127	52-0181	21"	2.15"
52-0137	—	21"	1.85"

Complete Wheels in stock for immediate shipment from V-Twin Mfg™. The original aftermarket wheel builders since 1969.

All front wheels on this page feature a chrome hub, with all internal bearings installed, choice of chrome or stainless spokes and chrome rim completely laced and trued.

Chrome Spokes Chr. Hub	Stainless Spokes Chr. Hub	Rim Diameter	Rim Width
1973 Only FX with single disc. Fits 35mm forks.			
52-0158	—	19" D.C.	2.50"
52-0174	—	21"	2.15"
1974-77 FX Clover Type with single disc. Fits 35mm forks.			
52-0165	52-0817	19" D.C.	2.50"
52-0161	—	21"	1.85"
1974-77 FX Clover Type with single disc satin hub. Fits 35mm forks.			
52-0187	52-0188	19" D.C.	2.50"
52-0189	—	21"	1.85"
1978-83 FX FXE-FXR with dual disc. Fits 35mm forks.			
52-0155	52-0818	19" D.C.	2.50"
52-0151	52-0819	21"	2.15"

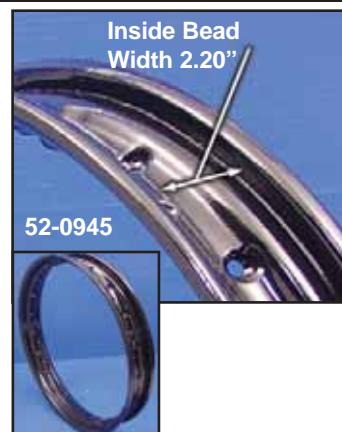

Replica™ Early Steel Wheel Rims feature conventional bead construction. **Note:** Spoke nipple holes may require enlarging before assembly with Aftermarket Spoke Sets.

VT No.	OEM	Fits	Finish	Size	Model
52-0947	43004-30	F&R	Black	18"	BT
52-0785	Powder	F&R	Black	18"	BT
52-0947	43004-30	R	Black	18"	45"
52-0948	43005-30	F&R	Chrome	18"	BT
52-0948	43005-30	R	Chrome	18"	45"
52-0961	3940-30	F&R	Black	19"	BT
52-0962	—	F&R	Chrome	19"	BT
52-0945	43002-30	F	Black	18"	45"
52-0946	43003-30	F	Chrome	18"	45"
52-0963*	—	F&R	Black	18"	
52-0964*	—	F&R	Chrome	18"	
52-0946	43003-30	F	Chrome	18"	K
52-0969	—	F	Chrome	19"	1952-63
52-0967	—	F	Black	16"	45 Solo
52-0966	—	F	Chrome	16"	45 Solo

*Note: Features reverse roll and deep dish spoke area to fit models with integral 1/2 brake drum.



Conventional Chrome Rims are flat style. Fits front tires only and has 40 holes.

VT No.	Dia	Width
52-0208	18"	2.15"
52-0202	19"	1.85"
52-0214	19"	1.60"
52-0203	21"	1.85"



Wheels with Twirled Spokes

Wheels with Twirled Spokes include chrome hubs with internals, rim and twirled chrome spokes assembled.

VT No.	Fits	Type	Width
FRONT			
52-0844	1980-83 FXWG	21" Dual	2.15
52-0860	1974-77 XL-FX	19" Single	2.50"
52-0846	1977-83 XL-FX	19" Dual/Single	2.50"
52-0944	1977-83 XL-FX	21" Dual/Single	2.15"
REAR			
52-0841	1973-82 FXE-FLH 1973-82 FLH	16" Rear & Front	3.00"
52-0850	1973-82 FXE-FLH	16"	4.00"
52-0177	1982-85 XL 1982-84 FXE 1982-86 FXWG 1984-85 FXR	16"	3.00"
52-0865	1954-78 XL	16"	3.00"
52-0883	1979-81 XL	16"	3.00"



Twirl Spoke Detail



3/4" Axle Spacer Saver use to hold axle spacers in place during rear wheel installation.

VT No. 16-0335

Chrome Wheels



Slotted Style



Spun Style

Chrome Cast Wheels are of aluminum construction. Ready to bolt on.

FX-FL 1973-84 Rear 16"

52-0798 Slotted Chrome

52-0838 Spun Polished



16" Star Chrome Rear Wheels

feature 5-spoke design with chrome plated texture finish on inner spoke area and smooth chrome on the machined outer spoke and rim area. Wheels include bearings installed. Fits 1973-84 FX-FL.

VT No. 52-1004



1973-84 Big Twin FX-FL Chrome 16" x 3.0 Wheel Assembly

is laced and trued with bearings installed and includes drilled steel rotor and chrome 51 tooth sprocket. Chrome bolts are also supplied for each side.

VT No. Disc

52-0428 10"

52-0429 11 1/2"



Wheel Bearing Greaser. Fitting & spigot greases 1973-99 tapered bearings without removing seals, use existing seal spacer or purchase separately.

VT No. Item

16-0803 Tool

44-0303 Collar



Hub Rebuilds

Hub Rebuild



1973-83 Hub Hardware.

VT No.	OEM	Item
12-0922	11027	Snap Ring
44-0501	43559-73	Washer

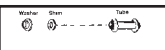

FLT Wheel Hub Hardware fit 1982-99 models, 1982-99 FXR models.

VT No.	OEM	Item
44-2024	43613-92	2.424" Spacer for narrow hub
44-2025	43608-82	4.308" Spacer for wide hub
44-2026	43650-82	Spacer Washer
44-2027	43290-82	.032 Shims, 10 pk
44-2028	43291-82	.016 Shim
44-2029	43292-82	.008 Shim
44-2030	43293-82	.004 Shim
44-2031	43294-82	.002 Shim
12-0371	41118-81	Inner Bearing Race, 1980-81 FLT

Spokes

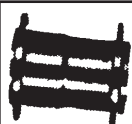

(A) 1930-36
VL Front
and Rear

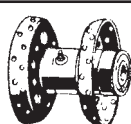

(B) 1936-
up BT, SV,
OHV



(C) 45" Solo
Front Hub 1938-
52. Sets include
20 short and 20
long spokes.

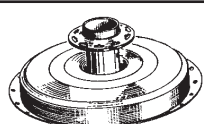

(D) 1952-63 K
and XL1/2
Drum Front
Hub

Order spokes by hub style as shown.

1930-36 VL FRONT AND REAR (A)

VT No.	Finish	Size	Rim
45-0735	SS	18"	C
45-0736	SS	19"	C

1936-up BT, SV, OHV (B)

VT No.	Finish	Size	Rim
45-0710	Cadmium	16"	DC
45-0757	Zinc	16"	DC
45-0651	SS	16"	DC
45-0409	SS	16"	DC
45-0720	Chrome	16"	DC
45-0621	Chrome, VT	16"	DC
45-0743	Parkerized	18"	
45-0744	Cadmium	18"	
45-0652	SS	18"	
45-0748	SS, VT	18"	
45-0721	Chrome	18"	
45-0601	Chrome VT	18"	
45-0653	SS	19"	
45-0602	Chrome VT	19"	DC

1938-53 45" SOLO FRONT (C)

VT No.	Finish	Size	Rim
45-0664 ²	Stainless	18"	C
45-0697	Stainless	18"	C, OE
45-0663 ^{1,2}	Stainless	16"	DC
45-0752	Stainless	16"	DC, OE

1952-63 XL-K FRONT (D)

VT No.	Finish	Size	Rim
45-0708	Stainless	18"	C
45-0707	Stainless	19"	C

Note 1: Fits VT No. 52-0224 Rim

Note 2: Cross 1 Pattern on Brake Drum Side

Note: 45 Solo Replica Front Rims (52-0966 and 52-0967) require OE type spokes, VT No. 45-0752

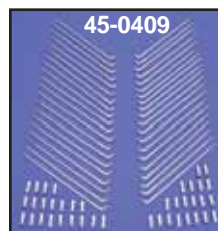

Deluxe Rear Hub

Rebuild contains all internal parts including longest length inner spacer (white 4.4480). Spacer can be cut down or collar removed for some applications. Fits 1973-82 FL-FX.

VT No. Bearing

44-0426 Timken

44-0428 Peer



Rear Wheel Bearing Race and Seal Kit. Three kits available for mag and wire wheel applications. Each kit includes two each bearing, race and proper seals.

VT No. Fits

44-0418	1982 FXR laced wheel
	1973-82 All FX-FL models with Laced wheel and 1980-82 FL Cast wheel
44-0419	1973-84, All FX models with laced wheel and 1973-79 FL Cast wheel
	1979-82 XL Cast or Wire Wheel

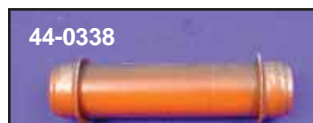

Inner Hub Bearing Tube Spacers may be used in some cast mag wheel applications, when flange is removed. Check for proper length fit.

VT No.	OEM	Model/Year	Front/Rear
44-0309	43549-36	1935-66 BT	Front & Rear
44-0310	43549-67	1967-72 BT	Front & Rear
		1971-72 FX	Rear
44-0315	41185-63	1963-78 XL	Rear

Steel Dual Flange Hub Spacer, Front & Rear

44-0338*	43601-78	4.420"	Orange
44-0336*	43602-78	4.434"	Yellow
44-0337*	43603-78	4.448"	White

Cast Wheel Hub Spacer, Front & Rear

44-2032*	43604-78	4.420"	Red
44-2033*	43605-78	4.434"	Yellow
44-2034*	43606-78	4.448"	White

Front Laced

44-0237	43668-82	FLT-FLST-FXST-WG
---------	----------	------------------

Aluminum Hub Spacer, Front

44-0311	43740-64	1954-72 XL 1971-72 FX
44-2035*	43635-74	2.148" Gold/Violet
44-2036*	43633-74	2.162" Red/White
44-2037*	43745-73	2.166"
44-0312*	43634-74	2.177" Green/Orange
44-1981*	43625-78	2.536" Gold
44-1980*	43624-78	2.550" Pink
44-0313*	43623-78	2.564" Violet
44-0362	43613-00	Front, XL-FXD

*Note: Choose proper length.



Adjustable Inner Hub Spacer for 1973-99 wire wheels and most custom wheel application.

VT No. 44-0639



1973-up Big Twin Hub Rebuild Kits contains bearings, races, seals, snap rings, seal retainer washers and seal spacers. Hub and internal bearing spacer not included.

VT No.	Fits
44-0450	1973-79 FL Cast Wheel Front/Rear 1973-83 All FX's Cast Wheel Rear Only
44-0451	1973-83 FL Laced Wheel Front & Rear 1980-83 FL Cast Wheel Front & Rear
44-0409	1973-82 FX-FXE-FXEF-FXEF-80-FXE-80 FXWG Laced Wheel Rear Only
44-0452	1982-83 FXWG, 1982 only FXS-80 Laced Wheel 1982-84 FXR-FXRS Laced Wheel Rear Only
44-0454	1982-83 FXR-FXRS Cast Wheel only

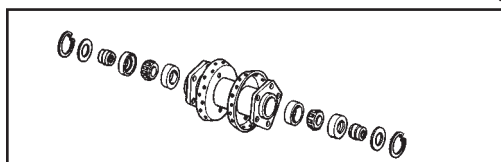

Front Wheel Assembly Kit for steel hubs only. Contains two each, bearing, race, seal and one each correct seal spacer. Also included for certain applications only are two each snap ring and seal retainer washers. Not included in this kit is the internal bearing spacer. This may be ordered separately. Check listing.

VT No.	Wheel	Fits
44-0455	Wire	1980-83 FXWG
44-0450	Cast	1973-83 FLH
44-0451	Wire	1973-83 FLH
	Cast	1980-83 FLH



Sealed Bearing Kit will replace tapered bearing and races on 1973-85 BT rear, all 1973-84 FLH front.

VT No. 44-0930



Wheel Seals. Note: VT No.14-0139 and 14-0658 feature metal housing all others are rubber covered.

James	VT No.	OEM	Fits
14-0659	14-0140	47519-83A	83-99 FX,, 85-99 FLST, Front/Rear Wheel Double Lip
—	14-0182	47519-83	1983-84 As Above
14-0657	14-0138	47519-58	1973-82 FX Rear Wheel 1973-82 FL Front/Rear Wire Double Lip
14-0658	14-0139	47519-72	1972-82 FX Front Wheel 1973-82 FL Front/Rear Mag Wheel
14-0622	14-0171	25414-82	Enclosed Chain Housing Seal for 1984 FXRT, 1982-84 FLT-FLHT
14-0664	—	12047	1980-81 FLT
—	12-0922	11027	Snap Ring

Hub Parts



Front Wheel Bearing, Race and Seal Kit contains 2 each, bearing, race and proper seals. Three kits available.

VT No.	Fits
44-0415	1980-83 FXWG laced 1973-83 FLH laced 1980-83 FLH cast
44-0416	1973-79 FLH cast 1973-83 FX-XL cast or wire 1982-83 FXR cast or wire



Genuine Timken Bearings Kit includes 2 tapered bearings and 2 races replacing 9052 for wheel 1973-99 Big Twin Swing Arm 1958-85.

VT No.	Item	U/M
44-0425	4 Piece Kit	Kit
44-0405	Race and Bearing	Pair
44-0406	Bearing Only	Each
44-0407	Race Only	Each



FX-FXE-XL FXR Front Internal Hub Kit includes all internal parts for complete rebuilding of all alloy front hubs. Includes inner spacer, bearings, races seals and seal spacer matched for each year group. Hub is not included.

VT No.	Type	Fits
44-0403	Drum	1964-72 XL-XLH, 1971-72 FX
12-0906	Drum	Snap Ring for Above
44-0402	10" Disc	1973-only FX-XL
44-0401	11" Disc	1974-77 FX-FXE-XL
44-0400	Dual Disc	1977-83 FX-FXR-XL



Wheel & Swing Arm Bearing and Seal Kit is a deluxe kit which includes 2 of each type of seal for 1958-71, 1972-82, 1983-99 year group of swing arm and wheel bearing application, with 2 tapered cone bearing assemblies.

VT No.	Item
44-1976	Deluxe Kit
12-0382	Bearing Only
12-0381	Race Only
12-0393	Bearing and Race Set



Star Hub Rebuild



1936-66 Internal Star Hub Component Kit includes internal rebuilding parts to assemble a bare hub. Everything pictured except hub. Includes standard rollers. Fits all interchangeable wheels

1936-66 if oversize rollers are needed order from our 9220 series in .0002 to .002.

VT No.	Years	Finish
44-0413	1955-66	Chrome
44-0431	1941-54	Parkerized



Deluxe Star Hub Rebuild Kit fits 1936-66 interchangeable hubs, includes inner and outer stars, screws, gaskets, thrust washers, outer bearing sleeve, snap rings, cork retainer washer and standard rollers.

VT No. 44-0414



Hub Thrust Plate Kit includes inner star, grease fitting, and outer chrome or parkerized star. Replaces 43569-55.

VT No.	Finish	Fitting
44-0535	Chrome	With fitting
44-0559	Parkerized	With fitting
44-0604	Parkerized	Without fitting

1967-72 Hub

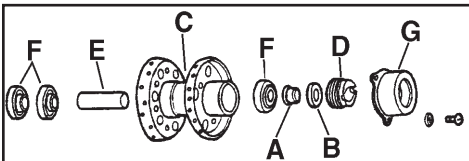

Internal Hub Parts for 1967-72 interchangeable hubs FL-FLH models.

VT No.	#	OEM	Item
44-0392	A	41196-55	Seal Spacer
14-0131	B	41210-55	Seal 5 pk
45-0673	C	43540-67C	Chrome Hub, Complete
45-0306	C	43540-67C	Chrome Hub, Bare
45-0758	C	43540-67	Black Hub, Bare
44-0526	D	43542-67	Locknut (Left Hand)
44-0310	E	43549-67	Inner Spacer
12-0331	F	43577-67	Bearing, each
44-0505	G	43592-70	Cover, Chrome

1967-72 Lock Nut and Seal Kit includes A, B and D.

VT No 44-0408



Replica Star Hubs include all internal parts, completely assembled, for front and rear.

VT No.	OEM	Year	Finish
45-0335	3958-36	1936-40	Parkerized
45-0330	43540-36	1941-66	Chrome
45-0323	43540-36	1941-66	Black
45-0880	3958-36	1936-40	Black

V-Twin replicated the "Star" Hub in 1980 with over 6000 being produced. All internals interchangeable with original and replaceable with components from our list.

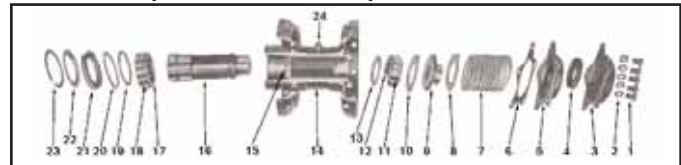

Star Hub Components. Available in packs for 1936-66 hubs. See complete kits on this page for rebuilding.

Index	Application	VT No.	OEM
1 & 2	Thrust Bearing Cover Screws & Lock washers	8200-10 8201-10 9670-10 15-0350	Chrome Cadmium Parkerized 43570-35
3 & 5	Small Cork	44-0535	43569-55
3	Hub Thrust Plate Kit	44-0527	43566-35A
3	Star Outer Cover, Chr.	44-2050	43566-35
3	As above, prkrzd w/hole	44-0465	43566-35
4	As above, chrome	15-0350	43570-35
4	Small Cork	15-0630	
4, 6 & 21	Gasket and Seal Kit	15-0637	
4, 6 & 21	As Above GB	15-0173	43576-35
6	Star Gasket	15-1054	James
6	Star Gasket		
7	Thrust Bearing	12-0708	43560-35
7	Adjustment Shims (10)	12-0720	
7	.002 Shim	12-9917 (10pc)	
8 & 10	.015 Shim	44-0524	43563-35
9	Thrust Washer (2)	44-0530	43556-35
9	Thrust Bearing Sleeve		
11 & 18	Bearing Roller Set, 26 required		
	Std. Size	10-0319	9220
	.0002	10-0320	9221
	.0004	10-0321	9222
	.0006	10-0322	9223
	.0008	10-0323	9224
	.001	10-0324	9225
	.002	10-0325	
12	Roller Retainer, Small	44-0531	24721-30
13	Roller Retainer Thrust		
	Washer, 1 used, each	44-0523	43552-39
14*	Wheel Hub Chrome	45-0330	43540-36
	Wheel Hub Black	45-0323	43540-36
	Wheel Hub 1936-40	45-0335	Assembly
	Thrust Collar	44-0534	43561-39
15	Inner Sleeve 1939-up	44-0309	43549-36
16	Roller Retainer, Large	44-0532	43578-35
17	Roller Retainer Washer		
19	1 used, 10 pack	44-0522	43558-39
20 & 23	Lock Ring, 2 used		
	10 pack	12-0921	43554-35
21	Large Cork	15-0631	43571-35
21	Large Cork, James	15-0231	43571-35
22	Retainer, Cork Washer		
	1 used	44-0521	43564-35
24	Grease Fitting 10 pack	44-0533	9851

Note: 14, Hub is assembled with all internal parts.



Internal Bearing & Hardware Kit for 1967-72 front and rear hubs. All parts necessary to build or rebuild a bare hub. Includes 3 bearings, tube spacer, seal, seal sleeve & hub lock (Left Hand Thread). Complete.

VT No. 44-0410



Rear Axle Parts

First Offered by V-Twin in 1981!

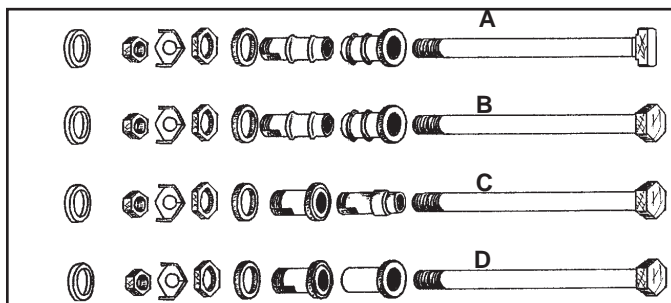

Rear Axle Kits include chrome axle, nuts, sleeves and spacers for each application. Nut kit includes outer sleeve and axle nuts chrome. Sleeve is included on types A, B, C and D.

Kit Cpt	Spacer	Sleeve	Axle only	Nut Kit	#	Axle OEM	Model/Year
44-0561	44-0343	44-0331	44-0216	9688-4	B	41551-41	1941-52 45 Solo Black
44-0349	44-0323	44-0331	44-0347	8832-4	B	41551-41	As Above, chrome
44-0360	44-0322	44-0330	44-0226	8160-4	B	41552-36	1936-57 Rigid BT (Hex)
44-0377	—	—	44-0231	9692-4	B	41552-36	1936-57 BT Hex Parkerized
—	—	—	44-0239	8160-4		41552-36	1936-57 BT Hex Chrome
						41552-36	1936-57 BT (Hex, Chrome)
44-0560	44-0322	44-0330	44-0215	8160-4	A	41552-36	1936-57 Rigid BT (Flat)
44-0348	44-0344	44-0330	44-0346	9692-4	A	41552-36	As Above Parkerized
44-0562	44-0321	44-0329	44-0214	8160-4	C	41552-58A	1958-62 FL BT
44-0582	44-0321	44-0355	44-0214	8160-4	C	41552-58A	1963-66 FL BT
44-0567	44-0353	44-0327	44-0213	8160-4	D	41552-67	1967-72 FX-FL
44-0563	44-0325		44-0212	8715-4		41552-73	1973-85 FX-FL, Chain
44-0564	44-0340		44-0218	8715-4		41580-79	1982-84 FXWG, FL Belt

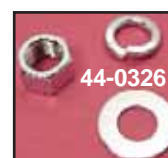

Chrome Rear Axle Nut and Washers for 1936-73 Big Twin, 5/8" x 18.

VT No.	Item
44-0326	Nut with washer kit
37-8118	Chrome Nut, 10 pk
37-8127	Nyloc-Nut, 10 pk
37-0963	Flange Nut, Each



Rear Axle Spacers.

Chrome	Zinc
44-0325	44-2051

Application

44-0655	44-0340
	1984-86 FXST Cast/Wire Wheel
	1973-82 All FL's Left Cast/Wire,
	1973-83 FX-FXE-FXEF-FXEF-80-
	FXWG Left Wire Wheel
	1981-86 FXE-80 Wire Wheel
	1973-86 All FX Cast Wheel
	1982 only Classic 1983-up FLH-80
	Cast or Wire, 1984-86 FXWG Wire
	1980-86 FXB-FXSB Cast Wheel

Chrome Rear Axle Nut & Washer Kit includes 2 extra thick washers, nut and lock washers for 1973-up, on square swing arms.

VT No.	Brand
8715-4	Colony
44-0520	V-Twin



Axle Protector Plates prevent axle nuts from scratching painted finish. Sold in pairs, polished stainless. 51-0643 fits Replica Rigid frames with forged rear axles plates.

VT No.	Fits	Type
37-8882*	Rigid Frame	Custom
51-0681	Rigid Frame	Custom
51-0680	Rigid Frame	Replica
51-0600*	Swing Arm Frame	Stock

*Note: Requires drilling & tapping at axle area. Drill and tap not included, screws included.



Rear Axle Kit replaces 41552-73 on 1973-84 chain drive FLH-FX, includes axle, pyramid adjuster blocks & chrome nuts. VT No. 44-1957



Chrome Rear Axle Kits fit 1973-84 FX & FL models. Kits include acorn or pike nuts.

VT No.	Type
44-0727	Acorn
44-0728	Pike



Rear Axle Seal Spacers.

VT No.	OEM	Application
44-0411	41196-73	1973-82 FX-FXE-FXEF-FXEF-80 FXE-80, FXWG, Wire Wheel 1973-83 All FL's Cast or Wire Wheel 1973-86 All FX's except FXWG-
44-0421	40906-82A pairs	1982-86 FXR's Cast/Wire Wheel 1984-86 FXST Wire Wheel wheel, 1982-86 FXWG Wire wheel 1982 only FXS-80, Wire Wheel 1982-86 FXB-FXSB Cast Wheel
44-0423	41196-82	1983-86 FLH-80 Wire Wheel, each
44-1944	40906-82	1982-84 FXR with Flange



Axle Adjusters



Calibrated Rear Wheel Adjusters feature chrome pyramid blocks with sight indicator to view calibrated adjuster bolt, for accurate and easy wheel alignment. Adjuster bolt is chrome heavy duty 1/2" rod with micrometer markings, nut is stainless steel. Fits 1973-85 FX-FLH, 1984-86 FXST
VT No. 44-2011



VT No. Item
8100-8 Complete Kit
8101-6 End Cover Kit



Complete Rear Wheel Adjuster Kit for 1973-85 Big Twin models includes pull adjusters, chrome end plates, plated hex nuts and chrome plated tapered lock nuts. End cover and nut kit also available.



Pyramid Adjuster Block Kit. Die cast chrome pyramid end caps with solid block type pull adjusters.

VT No.	Item	Model
44-0365	Kit	1973-85 FX-FL
44-0366	Blocks	1973-85 FX-FL
44-0485	Nuts	1973-85



Rear Axle Adjuster Sets.

VT No.	OEM	Models
44-0334	41570-77 47554-73	1973-84 FX-FL w/chrome end caps
44-2009	47554-73	Chrome End Cap only
44-0333	41570-77	Adjuster Pull only, pair
44-0600	41570-77 41112-79	1981-94 FXR, 1979-83 FLT Zinc
44-0603	41112-79	End Cap Outer for Above



Axle Protector Plates prevent axle nuts from scratching painted finish. Sold in pairs, polished stainless. 51-0643 fits Replica Rigid frames with forged rear axles plates.

VT No.	Fits	Type
37-8882*	Rigid Frame	Custom
51-0681	Rigid Frame	Custom
51-0680	Rigid Frame	Replica
51-0600*	Swing Arm Frame	Stock

*Note: Requires drilling & tapping at axle area. Drill and tap not included, screws included.

Rear Axle Hardware 1930-72



Rear Axle Nut and Lock Kit includes sleeve nut, collar, axle nut and lock clip.
Big Twin 1936-72

VT No.	Type	Finish
8160-4	Kit	Chrome
44-0316	Collar Only	Chrome
8161-4	Kit	Cadmium
9692-4	Kit	Parkerized
37-8791	Lock Clip	Parkerized
12-0617	Sleeve Nut	Parkerized



45 1930-52		
8832-4	Chrome	
8833-4	Cadmium	
9688-4	Parkerized	



44-0662	Lock Clip	Black
VL 1930-36		
9610-5	Chrome	
9611-5	Parkerized	
12-0617	Sleeve Nut	Parkerized

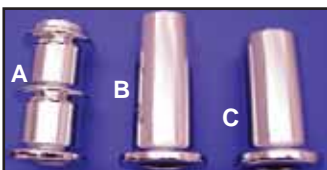

Outer Rear Axle Spacers for Big Twin.

Chrome	Zinc	OEM	#	Year
44-0322	44-0344*	41595-36	A	1936-57
44-0321	44 0339	41595-58	B	1958-66
44-0353	44-0354	41595-67	C	1967-72

*Note: Parkerized

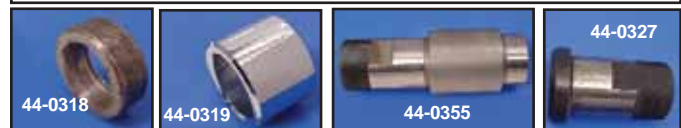
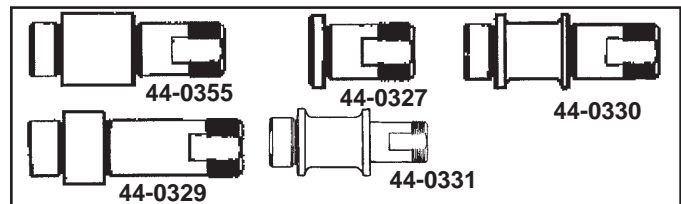

Rear Axle Sleeves for mechanical and hydraulic rear brake backing plates. *Note: Fit between back plate & swing arm.

VT No.	OEM	Year	Model	Item
44-0331	41718-41	1941-52	45"	Sleeve
44-0330	41600-36	1936-57	Big Twin	Sleeve
44-0329	41600-58	1958-62	Big Twin	Sleeve
44-0319	41596-58	1958-62	BT Side Plate	Spacer
	Chrome			
44-0355	41600-63	1963-66	Big Twin	Sleeve
44-0318*	41596-63	1936-66	BT Side Plate	Spacer
	Zinc			
44-0327	41600-67	1967-72	Big Twin	Sleeve



Rear Chain Adjusters are heat treated. Available in pairs with plated lock nuts assembled to insure proper fitting threads.

Chrome	Cadmium	Parkerized	Fits
7704-2	8014-2	9629-2	1936-72 Big Twin
7814-2	8479-2	9628-2	1930-52 Solo 45
9500-4	9501-4	9506-4	1932-73 Servi Car



Front Axle Kits

CLASSIC

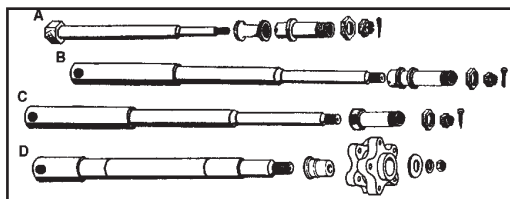

Front Axle Kits include plated axle, nuts, spacer and hardware. Axle sleeve included when required.

Year/Model	Kit	Spacer	Nut Kit	Axle	Axle OEM	Finish	#
1936-48 BT Spring Fork with Sleeve 44-0300	44-0581 44-1983	44-0304 44-0111	8162-3 9406-3	44-0209 44-0085	43872-36 (Black)	Chrome A Black	
1948-66 FL Glide, with Sleeve 44-0301	44-0568 44-0225	—	8162-3 8163-3	44-0200 44-0224	43875-48 43875-48	Chrome B Zinc	
1967-71 FL Glide, with Sleeve 44-0302	44-0569	—	8162-3	44-0201	43875-67	Chrome C	
1972 only FL Glide with spacer and flange	44-0240	44-0397	8769-3	44-0228	43875-72	Chrome D	
1973-80 FL Glide, 1980-83 FXWG	44-0570	44-0303	8769-3	44-0202	43875-73	41	
1981-85 FLH	44-0571	44-0303	8769-3	44-0203	43867-81	41	
1970-72 FX (Zinc)	44-0573	—	44-0308	44-0204	43871-52	33	
1973-77 FX	44-0574	—	8768-3	44-0205	43871-73	35	
1977-83 FXE	44-0576	—	8768-3	44-0206	43883-77	35	

Axles have chrome plated ends, except as noted. Order nut kit separately.

VT No.	OEM	Fits	Finish
44-0209	43872-36	1932-47 Springer Type Fork	Chrome
44-0085	43872-36	As above	Black
49-1963	43871-30	1930-52 45" Solo	Black
49-0260	—	1941-44 WLC	Black
44-0200	43875-48	1948-66 FL	Chrome
44-0224	43875-48	As Above	Zinc
44-0228	43875-72	1972 only	Chrome
44-0201	43875-67	1967-71 FL	Chrome
44-0202	43875-73	1973-80 FL, 1980-83 FXWG	Chrome
44-0222	43875-73	As above	Zinc
44-0203	43867-81	1981-85 FLH	Chrome
44-0208	43346-83	1983-86 FXWG, 1981-85 FLH-80, 1984-99 all FLT, 1984-up FXST	Chrome
44-0204	43871-52	1952-72 XL 1970-72 FX	Zinc
44-0205	43871-73	1973-77 XL-FX	Chrome
44-0206	43883-77	1978-83 XL's	Chrome
		1977-83 All FX except FXWG	Chrome



Big Twin Front Axle Cap Cover Sets include right and left caps with set screws for glide type forks. Cap included for anchor stud on 37-0035 only.

VT No.	Type	Year/Model
37-0035	3 pc	1949-71 FLH
37-0034	2 pc	1949-71 FLH
37-0038	Ball	1972-up FXWG-FLT-FXST-FLH
37-0036	Cap	1972-84 FXWG-FLT-FXST FLH and XL-FX with 39mm

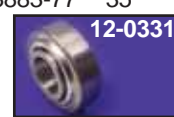
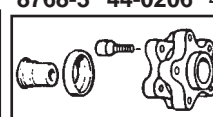

Left Side Disc Hub Flange is used when large type disc caliper is mounted to glide FL fork on 1972 only.

VT No.	Type
44-0240	Complete Hub Flange Kit with axle
45-0314	1967-72, Flange only
44-0397	Spacer Left
44-0228	Chrome Axle Only
12-0331	1967-72, Flange Bearing only
23-0440	Chrome Lug Bolt Set



Pike Front Axle Nut Kit fits 1972-up WG, 1984-up ST models and 39mm FXR and FXD.

VT No. 2263-2

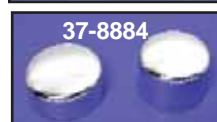

Chrome Axle Nut Caps Set for both axle nut and axle head where required, set screws and hex key wrench. Each cap has an internal hex to allow more thickness for the set screws thread to eliminate thread stripping. Note: These axle caps will not work on late model rear axles with cotter key locking devices.

Front	Rear	Fitment
37-0039	37-8885	1982-86 FXWG
37-0039	37-8884	1980-81 FXWG
—	37-8885	1981-85 FX, Except FXWG-FXST
—	37-8884	1973-80 FX, Except FXWG
	37-8886	1971-72 FX
37-0039	37-8885	1980-94 FLT
		Does Not Fit Rear 1989-94
37-0039	37-8885	1981-84 FLH
37-0039	37-8884	1973-80 FLH
37-0039	37-8886	1972 FLH
37-0039	37-8885	1981-84 FLH
37-0039	37-8884	1973-80 FLH

Note: 37-8880 each, remainder in pairs



Front Axle Spacers



Front Axle Spacers

Chrome	Zinc	OEM	Side	Application
—	44-0397	43885-72	L.H	1972 only 74 FLH
44-0653	44-0303	41594-73	L.H.	1973-86 FL, FLH, FLH-80, Classic 1980-82 FXWG
44-0657	44-0295	41607-83	R.H.	1983 FXWG



Speedo Drive Spacer replaces drive units. Fits 1973-83 FX.
VT No. 44-0390

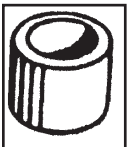

Front Wheel Seal Spacers sold each, except noted.

VT No.	OEM	Side	Application
44-0391	43548-73	L	1973 XLH-XLCH-FX-FXE
44-0305	43548-74	L	1974-77 XLH-XLCH-FX-FXE
44-0306	43488-77	L	1978-95 XL-XLS-FX-FXE-FXEF FXEF-80, 1982-83 FXR-FXRS-FXRT
44-0411	41196-78	R-L	1973-84 FL-FLH-FLH-80 1980-86 FXWG, pair
44-0299	41196-83	R-L	L1983-84 FLH-80



1932-47 BT Front Axle Spacers.

VT No.	OEM	Finish
44-0304	43884-36	Chrome
44-0111	43884-36	Parkerized



Front Axle Nut Kits are chrome or cadmium finish. Models which require sleeve nut, brake drum models, it is included along with castle nuts and cotter pins.

VT No.	Finish	Model
8162-3	Chrome	1946-71 Big Twin
8163-3	Cadmium	1946-71 Big Twin
9405-3	Chrome	1930-36 VL, 1936-45 Big Twin
9406-3	Parkerized	1930-36 VL, 1936-45 Big Twin
8852-4	Chrome	1929-36 45 Solo
8853-4	Cadmium	1929-36 45 Solo
9689-4	Parkerized	1929-36 45 Solo
8854-4	Chrome	1929-36 45 Solo
8855-4	Cadmium	1937-52 45 Solo
9690-4	Parkerized	1937-52 45 Solo
8162-3	Chrome	1930-71 Servi
8163-3	Cadmium	1930-71 Servi
9890-7	Cadmium	1952-66 Hummer
44-0308	Chrome	1971-72 FX (Nut Only)
8768-3	Chrome	1973-up FX-XL
8769-3	Chrome	1972-up FLH & WG
44-0599	Chrome	1972-up WG



Front Axle Nut replaces 7734W, 1/2 x 20 threads, Zinc.

VT No.	Type
44-0307	Each
44-2013	5 pk

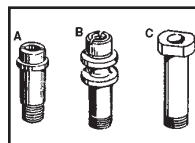

Front Axle Sleeves.

VT No.	#	OEM	Fits
44-0300	A	43882-36	1937-48 BT
44-0301	B	43882-48	1949-66 FL-FLH
44-0302	C	43882-67	1967-71 FL-FLH
12-0537		43886-30	Sleeve Nut

Front Hub Caps



Chrome FL-FLH Front Wheel Hubcaps. Full 8" dresser hubcap for wire wheels to fit between hub and axle without additional hardware.

VT No.	OEM	Years	Model
49-1998	43330-48	1936-57	Springer
45-0405	43303-49	1948-66	FLH
45-0406	43304-67	1967-72	FLH
45-0666	43304-73	1973-80	FLH
45-0667	44463-82	1981-84	FLH
37-8349	Fits	45-0405	Plug

Replica Chrome Hubcap replaces factory accessory 11260-46 to fit 1936-66 front and rear Big Twin.

VT No. 45-0400



4 1/2" Front Chrome Hubcaps fit between hub and axle without additional hardware. Fits 1981-84 FLH.
VT No. 42-0668



Rear Hub Cap fits 1936-57 Rigid BT.
VT No. 45-0669



1973-95 Chrome Mini Cap fits between swing arm and axle spacer.
VT No. 45-0692



1936-48 BT "Atlas" Front Hub Cap is of alloy construction and acts as a hub cap and axle spacer on BT Twin Spring Forks.
VT No. 49-0968



8" Spring Fork Hub Cap in chrome, replaces 43000-48. Fits all 1936-48 74", 1941-57 Servi-car front wheel.
VT No. 49-1998